

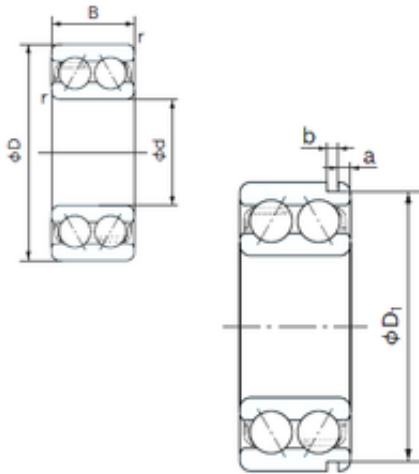

# KOYO MANUFACTURING (THAILAND)CO.,LTD.



90 mm x 160 mm x 52.4 mm NACHI 5218AN  
angular contact ball bearings

Bearing No. 5218AN

5218AN Bearing 2D drawings and 3D CAD models

|                               |                  |
|-------------------------------|------------------|
| Size                          | 90x160x52.4 mm   |
| Bore Diameter                 | 90 mm            |
| Outer Diameter                | 160 mm           |
| Width                         | 52.4 mm          |
| d                             | 90 mm            |
| D                             | 160 mm           |
| B                             | 52.4 mm          |
| C                             | 52.4 mm          |
| a                             | 4.9 mm           |
| b                             | 3.1 mm           |
| r min.                        | 2 mm             |
| D1                            | 155.22 mm        |
| Weight                        | 4.28 Kg          |
| Basic dynamic load rating (C) | 129 kN           |
| Basic static load rating (C0) | 125 kN           |
| (Grease) Lubrication Speed    | 2500 r/min       |
| Bore Type                     | Cylindrical Bore |
| Enclosure                     | Open             |
| Configuration                 | Double Row       |
| Bore Size                     | 85 mm            |
| Outside Diameter              | 160 mm           |
| Width                         | 52.4 mm          |
| Fillet Radius/Chamfer         | 2 mm             |
| Groove Width                  | 3.1 mm           |
| Groove Diameter               | 155.2 mm         |



## KOYO MANUFACTURING (THAILAND)CO.,LTD.

|                         |                   |
|-------------------------|-------------------|
| a (max)                 | 4.9 mm            |
| Dynamic Load Rating     | 129,000 N         |
| Static Load Rating      | 125,000 N         |
| Limiting Speed - Grease | 2,500 rpm         |
| Limiting Speed - Oil    | 3,500 rpm         |
| Radial Clearance        | 0.012 to 0.036 mm |
| da                      | 100 mm            |
| Da                      | 150 mm            |
| Dx                      | 172 mm            |
| ra                      | 2 mm              |
| Cy                      | 7.4 mm            |